

# Grindings

**Idaho Gem Club, Inc.**

P.O. Box 8443 ▼ Boise, Idaho 83707-2443

VOL 70 NO 3

March 2010



## **BOARD OF DIRECTORS**

**Jason Madsen**  
President  
378-4666

**Willa Renken**  
1st Vice President  
362-3941

**Brent Stewart**  
2nd Vice President  
863-9336

**RECORDING SECRETARY**  
Deana Ashton  
891-7273

**Phil Neuhoff**  
939-4508

**Ed Moser**  
340-8060

**Rick Corbett**  
383-9930

**Twila Gallaher**  
853-6703

**Dan Phillips**  
585-3019



**TREASURER**  
**Kathy Griffin**  
467-9286

**NFMS DIRECTOR**  
**Charles McCreath**  
344-5085

**EDITOR**  
**Doug Renken**  
362-3941  
WLR\_DKR@MSN.COM

**CLUB WEB SITE**  
[www.idahogemclub.com](http://www.idahogemclub.com)

## **President's Message**

Thank you to everyone for their work to make the 2010 show so successful! There was terrific attendance throughout the weekend with over 4000 people attending in all. It takes a lot of people and effort to pull off the show. Thank you to all those who gave a helping hand. I was impressed with the wonderful displays, several of which were fist timers and three Junior's displays. I herd from several first comers to the show that they were impressed with the quality and variety of materials and activities available.

License Plate sales are underway. I have seen many plates proudly displayed on vehicles already. Purchasing a plate is a great way to support Earth Science education programs as well as show off your enthusiasm for living in the "Gem State".

It is time to round up your buckets and gather your tools. Our first field trip for the year will be to the Queenstone and Wangdoodle claims on March 20th. Please attend the General meeting to find out the latest details. Remember to drink plenty of water, wear appropriate clothing, be mindful of critters, and have a great time.

*Jason Madsen*  
*President*

**MINUTES OF THE IDAHO GEM CLUB  
BOARD MEETING ♦  
MARCH 2, 2010**

Present: Ed Moser, Phil N., Brent Stewart, Jason Madsen, Rick Corbett, Twila Gallaher, Deana Ashton

Guests: Charles Osgood, Gene Stewart, Joe Nielsen, Kathy Griffin

There was a correction to the Feb Board minutes; Phil Neuhooff was excused from last meeting- Twila moved to accept, Willa 2nd motion to accept corrected minutes. The motion was approved.

Secretary's report: Jason reported that the Annual report from January meeting has been submitted to the lawyer for recording. I would like to thank Belle Witt and Kathy Griffin and Jason Madsen for standing in for me as I was not present for one meeting and late for two others. I do appreciate it very much!

Treasurer's report-Kathy wasn't able to have a printed report so she went over the income as deposited in the bank

Federation Report: Chuck excused today-doing well after surgery. Chuck and Shirley will be excused from the fed. mtg in april.

Committee reports:

Field trip: March 20th to Whangdoodle Rick Corbett reported on how to prepare to collect the opal here. Bring lots of water and pray for sun. The group will also be going to Queen stone as well.

Program- Brent is working on doing a program for March

Mining Claims-no report

Junior s-Since Doug wasn't at the meeting Ed gave his written report for the newsletter to Willa Thanks everyone for help at the kids table during show- the generous donation of tourmaline will need to be sorted because of the sharp edges

found on some of the specimens. Ed will sort them later and they will be used for the youth at a later date.

Editor- Doug not present

Show: Bills from the show were received, processed and will be delivered on Wednesday.

Tables: Replacement of the wooden tables was heavily discussed. Replacement with lighter more durable plastic tables is favored. Expense could be offset by selling old wooden tables and putting proceeds towards new plastic tables- but will be discussed further. Willa suggested that we adjust the budget to buy new tables over a period of 3 years. It was suggested that the old wooden 8' long tables be offered for sale to club members as we replace them each year. More discussion will be had over this issue.

The case fronts need some refurbishing...Brent mentioned the flyers for next year should include "44th " or the correct year of annual sale. There was discussion on Show hours and that closing on Sat at 6pm should be considered Jason will talk to Charlie Smith to get his input on this issue. The Garnet table will need hosts next year as Mike and Sue Witschen will not be able to do it next year and should be thanked for many yrs of hosting this venue.

Sweatshirts and t-shirts sold=55!! Way to go Joe! Joe Nielsen will store the clothing rack for t-shirts and sweatshirts at his home and bring it to meetings etc when needed. Shirts from year past will be offered at a discount for club members at the upcoming meeting.

Board There was some discussion on the setup and tear down. The tear-down went well, at the Expo there were lots of volunteers and it was a smooth process loading the U-haul. We will need to have more volunteers go over with the cases so they can be unloaded and packed up a little faster.

Twila thanked all 72 members who filled regular cases and the 19 black light displays. All of the displays were very well received by the public. The cases all looked very nice. Our juniors

were an added plus and let more of the public know we have an active juniors program.

Phil Neuhoﬀ discussed the Scholarship Program.

He has revised the application for scholarship to eliminate personal questions and add pertinent information. He proposed moving the August 15th deadline into September in order to allow students more time to apply for the scholarship. He added an essay to explain why the student wants a degree in Earth Sciences and also a requirement to have a professor sign the application.

Jason appointed Charles Osgood as Chairman to administrate over License Plate Program. He will be assisted by Gene Stewart. Ed Moser made a motion to allow Charles Osgood as License Plate Chair to use some of the license plate funds to create information packets to distribute to various clubs and venues for advertising purposes. The motion was seconded by Brent Stewart. Discussion was opened and a heavy discussion on advertising ideas and promotion of plates was had and will continue at a later date. Willa called for a vote on the motion. Jason asked if any of the Board members approved or were against. The motion was approved. Public lands advisory to be discussed at next meeting.

Ed also mentioned members should visit the Caldwell library display of rocks.

Membership applications! 13 new members (families) were reviewed and accepted. Twila made the motion to accept, Rick 2nd. The motion was approved. New members: Delores Dewayne, Terry and Marcy Belcoe, Jerry and Jane Smart, David and Carol Smith, Jim and Barb Wilson, Ron & Pam Mawson, ARene Ceily. The meeting adjourned at 9:40.

*Respectfully submitted,  
Deana Ashton  
Secretary*

## Idaho Gem Club's Silent Auction Table for Show 2010

I would like to thank all the great volunteer's for helping at the silent auction this year. Their help made the auction run smoothly and I truly appreciated all their hard work. I hope they enjoyed the time they spent digging through the buckets of rocks and filling the white paper plates with the variety of rocks we had for all the kids young and old to buy. I received a great suggestion from Larry Friend on how to make the area work a little better next year and if you have any suggestions that would make the auction table work easier please let me know.

I set up a small area for the kids to buy quartz crystals I dug up from Crystal Park, Montana, a few years ago with a small geode from either Beacon Hill or Succor Creek to accompany the quartz crystals. I had two pint Tupperware containers full of small crystals and I almost made them last the full two days of the show. I placed an average of five to six crystals on the plate and started the auction at 25 cents. I first started with one plate, then added a second plate and finally had three plates out at the same time to keep the kids from fighting over the plates of crystals.

I would like to thank Scott Madsen for donating all the specimen's; the five emeralds, two amber, six quartz crystals, four aquamarines, two citrines, two rutilated quartz crystals, two amethyst crystal clusters, a multi-display of beautiful multi-colored tourmaline, I am sure I have missed a specimen. I would like to give a shout out to Jim Storey for running the verbal auction at the silent auction table this year. He did a great job and the verbal auction was a wonderful success. All of the specimen's sold to some very happy people Saturday.

I want to thank you for all your help: George Cawthon, Ron Coolbaugh, Larry Friend, Jim Kirschbaum, Ron Ridenour, Bob Turner, Jim Clinton, Carl Woodland, Mike Jones, Deb Knudsen, Laura Lindsay, Jack Trevithick, Richard Clark, Bill Belknap, Kitty Bryner, Gordon & Diane Roberts, Austin Brittenham, Scott Madsen, Don Nafus, and Ilse Schreiner. If I missed anyone in this list please forgive me for I lost my sign up sheet during the tear down of the show Sunday night.

*Best regards,  
Cheryl Link,  
Silent Auction Chairman*

## Gem Show 2010

Thanks to all the individual club members who helped out this year. The annual gem mineral and fossil show was once again a resounding success. The turnout for setup and tear down was tremendous and we managed to set another record this year. The efforts of the demonstrators are always appreciated as they were again this year. They show the public the many talents they have learned in the lapidary field. Willa did a wonderful job arranging our demonstrators through out the building, giving more people the opportunity to see each persons expertise. As always the display cases were once again spectacular. Twila worked very hard to see everyone that contacted her was given their space to display some very unique materials. Mike Jones and Laura Lindsey did a wonderful job with the grab bags and wheel of fortune. They would like more bags filled for next year. So with the show barely in our rear view mirror I will start reminding you now to sew more bags and keep your tumblers going. I would like to give a heart felt thanks to the com-

mittee chairs for their efforts in scheduling the people who worked the different venues during the show. The volunteers were enough to keep all the tables manned and the money securely taken care of. We appreciate all the individual efforts provided by all of you and thank you for once again making this year's show profitable, productive, and special for all those who came.

*Doug Renken  
Assistant Show Chairman*

## IGC Show Host Thank You

Thank you to everyone who helped greet and guide our guests at the recent show! My wonderful helpers included: Diane Perkins, Debbie Knudsen, Nancy Schlossman, Kathy Griffin, Karol Cawthon, Dan Conley, Ron Coolbaugh, Ruth Brittenham, Myrtle Trevithick, Erin Snyder, Mike Snyder, Clarence Buersmeyer, and Twila Gallaher. I really appreciate your help and I'm sure our guests were glad you were there to help them too!

*Gratefully, Cathy Parsons*

## ROCK'N FUNNIES



Welcome New Member

**Dat & Sandy Mooney**  
**1308 W. Eagle**  
**Nampa, ID 83651-8831**  
**(208) 602-1171**

**Larry Odell**  
**12914 Alexa, St.**  
**Caldwell, ID 83607-5118**  
**(208) 461-3235**

**Robert Drake & Rindy Quijas**  
**P.O. Box 512**  
**Horseshoe Bend, ID 83629-0512**

**Mark Ruiz**  
**5619 Edson St.**  
**Boise, ID 83705-1852**  
**(208) 954-1013**

**David & Carol Schmitz**  
**1946 E. Stoney Brook Ct.**  
**Eagle, ID 83616-6640**  
**(208) 939-9077**

**A. Rene Seeley**  
**3939 S. Arno Ave.**  
**Meridian, ID 83642-1396**  
**(208) 288-0122**

**Terry & marcy Belcoe**  
**P. O. Box 1644**  
**McCall, ID 83638-1644**  
**(208) 634-9719**

**Randy & Tammy Brown**  
**10260 W. La Fontan Dr.**  
**Boise, ID 83709-0439**  
**(208) 323-7655**

**DeLorese Dewayne**  
**2200 Skilern Dr.**  
**Boise, ID 83709-2764**  
**(208) 407-4750**

**Debbie Griffith**  
**P.O. Box 423**  
**Horseshoe Bend, ID 83629-0423**  
**(208) 870-5217**

**Ron & Pam Mawson**  
**2217 S. Amy Ave.**  
**Boise, ID 83706-4403**  
**(208) 906-2224**

**Jerry & Jane Smart**  
**5509 N. Cresswell Ave.**  
**Boise, ID 83713-1740**  
**(208) 939-2280**

**Jim & Barb Wilson**  
**P.O. Box 2336**  
**Nyssa, OR 97913-0336**  
**(208) 741-0021**

# HAPPY BIRTHDAY



## MARCH

3/1 Tristen Griswold  
 3/2 Heide Finnegan  
 3/4 Pat Mooney  
 3/5 Gene Alvey  
 3/5 Katy Griswold  
 3/5 Debbie Kennedy  
 3/6 Jean Dingley  
 3/6 Jason Madsen  
 3/7 Ronald Dingley  
 3/7 Judy Blodgett  
 3/10 Ron Harrison  
 3/18 Roger Nelson  
 3/18 Vicki Bickford  
 3/20 Robert Dewey  
 3/22 Joshua Jackson  
 3/23 Judy Lee  
 3/24 Victoria Kowalski  
 3/28 Larry Friend  
 3/30 Diana Harshman  
 3/30 Heather Madsen  
 3/31 John Meyer  
 3/31 Bonnie Sue Cooper

**March Birthstones**  
**Faceted - Aquamarine**  
**Cabochon - Bloodstone**

## APRIL

4/2 Sherri Potts  
 4/3 Bill Marsh  
 4/3 Marcy Belcoe  
 4/8 Phyllis Marsh  
 4/9 Hannah Longstroth  
 4/10 Douglas Williams  
 4/11 Tom Cooper  
 4/12 Nathaniel Loewen  
 4/12 Joyce Murray  
 4/13 Rick Olmstead  
 4/13 Edwin Moser  
 4/14 Emily Benda  
 4/15 Dorothy Snowball  
 4/17 Jim Da Silva  
 4/22 Willa Renken  
 4/24 Neil Potts  
 4/26 Vern Boyd  
 4/27 Terry Belcoe  
 4/28 Kyleigh Jackson

**April Birthstones**  
**Faceted — Diamond**  
**Cabochon — Rock**  
**Crystal**

## Upcoming Show

**Magic Valley Gem Club Show**

**March 2010**

**13th 9am - 6pm**

**14th 9am - 5pm**

**Twin Falls County Fairgrounds (New Location!)**

**Admission \$2.00**

## DATES TO REMEMBER

### GENERAL MEETING:

**3rd. Tuesday of every month**

March 16, 2010

Church of the Brethren

2823 N. Cole Road, Boise, Idaho

Meeting Starts at 7:30 pm.

### BOARD MEETING:

**1st. Tuesday of every month**

April 6, 2010

Church of the Brethren

2823 N. Cole Road, Boise, Idaho

Meeting Starts at 7:30 pm.

## March Refreshment Committee

Chair: Arlene Bailey 562-8030

Randy Lee 870-1005

Heather Madsen 378-4666

Valerie Estabrook 859-1233

### REFRESHMENT COMMITTEE GUIDELINES

Need approximately 15 dozen cookies. Wrapped door prizes are also needed. Arrive early enough to set up the chairs. The chairperson brings the coffee urn, coffee, punch, cream, sugar, cups and napkins. Afterward, put meeting tables & chairs away, clean kitchen and sweep the room. Gather and take all the trash with you. Don't forget it is the responsibility of the chair for the coming month to pick up the coffeepot, take it home and bring it the next meeting.

## April Refreshment Committee

Chair: Deb Shaffer 871-8830

Kerri Chipman 871-8830

Cheryl Link 375-5360

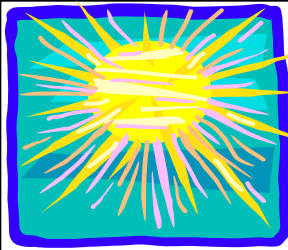

## Sunshine Lady

Arlene Bailey is the club sunshine lady. Her job is to send some cheer to members who are ill or just need some cheering up. But she needs your help in doing this job. If you know of someone who has been recently ill let her know so she can send them a card. Her phone number is 562-8030. Thank you in advance for your help.



*Remember to collect and bring Teddy Bears to the meetings for our public service project. The bears and other stuffed animals are given to emergency personnel to give to the children at the scene of emergencies. Please give your animals to Debbie Knudsen or Skeeter Eversburg. **THANK YOU!***

## Juniors Report

I would like to thank all those who helped and brought material for the kid's critter table at the show.

The juniors will meet in the room where they will be working on their project.

The donation jar from the show was \$66.54 for the youth.

Thanks to the club members who have donated rock samples for the youth I have some that are still to be sorted.

*Ed Maser  
Cell 340-8060  
Juniors Chair*

## Idaho Gem Club March Field Trip

### Queenstone\_Wang Doodle Field Trip

**What:** We'll be collecting jasper and opalene at Queenstone; common and possibly some fire opal at Wang Doodle.

**When:** March 20th 2010

**Meet** at KMart at the intersection of Hwy 55 (Karcher Rd.) and Caldwell Boulevard between 8:30 a.m. and 9 a.m. Take Exit 33A (last Nampa exit West of Nampa) cross over the freeway, stay on Karcher Rd. and meet us in the parking lot on the south side of KMart. Departure time will be at 9 a.m.

We will travel West on Hwy 55 through Marsing to the intersection of Hwy 55 and Hwy 95. We will make a fifteen minute stop at the ION Truck Stop, departing there at about 9:40 a.m. From the ION Truck Stop go South on Hwy 95 to Sommercamp Rd., this is just before the DOT weigh station.

Equipment needed: rock hammer, shovel, bag or bucket for specimens collected, appropriate clothing for the weather and location, lunch, water, fuel, and any items you need for your personal use. If you would like more information, please come to our Gem Club Meeting:

March 16th, 7:30 p.m. at the Mountain View Church of the Brethren 2833 N. Cole Rd. or Call our Field Trip Chairman

*Tony Griffin*

*Field Trip Chairman*

*467-9286 home phone*

*250-3857 cell phone.*

*Email: [tonygriffin@heritagewifi.com](mailto:tonygriffin@heritagewifi.com)*

## My trip to Tucson and the Gem Show

I left on Sunday, February 7, 2010 to drive to Tucson, Arizona to attend the Gem and Mineral Show and visit my brother David in Cascabel, Arizona. It's a long drive by yourself! I'd originally planned to take my brother Alan along with me, but his recovery from cancer surgery and chemotherapy (brain and lung cancer) is a very long, slow process and he wasn't up to the trip. I drove through Las Vegas and stayed at a casino in Boulder City on Sunday night and then drove on down to Tucson on Monday, arriving at about 4 pm. My brother had arranged housing for me in a "straw bale" building (covered in stucco) that he shares "ownership" with several other folks so it only cost me \$5 a night. It had some kitchen facilities, a TV, a bed, a bathroom, refrigerator so it was more than adequate!

On Monday, I found a map of Tucson and made my way to the Visitor's Center to find some information about the "show." Well, I got a lot of information – and there's a LOT of places to visit. Fortunately, I was only a short way away from one of the sites and the folks at the visitor's center directed me to the JG&M Expo on Simpson Street. There were quite a few vendors there and they did sell to the public so I enjoyed wandering thru the site looking at incredible amethyst cathedrals and massive slices of Arizona petrified wood (collected from about 30 feet underground) and trunks, etc., along with kopal, beads, turquoise, and many other beautiful gems and minerals.

They also offered free shuttle service to other sites, so I caught one to Howard Johnson, La Quinta Inn, Days Inn, etc., and wandered through those vendor sites for the rest of the day (I walked thru 8 or so sites around Speedway/Drachman/Grant Street for about 5 hours). The number of vendors was incredible and the minerals, stones, fossils, etc. were also incredible. Many vendors sold only to dealers and the sites/routes weren't very clear but they still let me wander through to look. Many vendors at the hotels displayed and sold their materials directly out of their hotel rooms. I finally caught back up with the shuttle and made my way back to the Simpson Street site and drove back to my lodgings about 6 pm when the sites closed for the day.

On Wednesday, my brother arrived from Cascabel (26 miles N into the cacti (deep woods) from Benson, Arizona, and I showed him the Simpson Street site and then we caught the shuttle to the sites on the West side of the freeway - just seemed like miles and miles of vendors/tents/material. So, we walked around there for awhile and a huge wind storm swooped in and it started to rain really hard and we got cold and wet so caught the shuttle back to the Simpson site and went "home" to dry off and warm up.

On Thursday, David went home and I went to the Tucson Convention Center to the Tucson Gem and Mineral Show. Once again, there were a lot of vendors but this time they all sold to the public! And, there were many beautiful cases, art work, moon rocks, etc. on display. I also saw Allan Young!!!! The whole show was beautiful!



Later that afternoon, I drove about 2 ½ hours further south to Benson and then another 26 miles NE to Cascabel (close to the Saguaro Wilderness) which is out in the deep “cactus boonies” to stay with my brother for the night. It’s an interesting site and he makes huge gongs out of old propane/gas cylinders there along with his other steel/metal work hobbies. Another of the co-owners of the site has her own house there but has used the straw bales as the base for a stucco wall around the patio area to keep out snakes and other critters.

I left Friday afternoon and drove to Kingman, Arizona and stayed overnight there. On the way, I passed two really bad traffic accidents which slowed traffic to a crawl (in the first a train had slammed into a pickup truck; and there were at least 4 vehicles in the 2nd wreck). I got to Las Vegas in time to get trapped in traffic jam just outside of Vegas on Highway 93. It seemed the cops were diverting traffic in a circle so I went around from Las Vegas Blvd to the Northern Beltway (215) and back around and there were several hundred vehicles in the same loop so there must have been a bad accident on Highway 93 North just past that intersection. We were all trapped there a couple of hours and it didn’t look like they were opening it up anytime soon so I looked at my map and Highway 95 looked like it went North so I found it and went West on 215 to Highway 95 and went west and north to Tonopah and then East and North to Ely and stayed overnight at the Hotel Nevada in Ely. I made it back home safe and sound about 4:00 pm on Sunday the 14th.

It was a long but interesting trip. If I go again, I will try to find more information about the various gem show sites before I go—there are so many and I only saw a few but it’s nice to be home!

*Cathy Parsons*

## ***Yesteryear June 1959***

A picnic was planned for the July meeting at the Municipal Park. The field trip was to Beacon Hill. Field trips left at 8 A.M. from the front of the State House. All filings on the club claims have been completed.

The August field trip was scheduled to be in an area near Weiser where petrified fruits were found. The September field trip was to Warm Springs.

The case of material the club sent to the Federation Show won a blue ribbon and a plaque, which will be held for one year and then sent on to the next club winning at the NWFS .

Price of the Campus School went from \$20.00 a year to @10.00 a month. Members voted in favor of Willow Creek for the November field trip.

The Campus School gave permission for the use of the facilities for the Gem Show at a cost of \$36.00 a day plus the cost of one person to man the kitchen.

Arrangements were made at the Hill House for the annual Banquet at \$2.00 per plate.

At the Christmas party the Idaho Power Choraliers sang several songs, Mrs. Lesser gave the story of the Tucloe Stones of the Bible using Gem Material mentioned in the Bible and a large map to show where the stones were believed to have been found. Cookies, coffee and punch were served.

(Love Lake is probably Love Reservoir-due west from Beacon Hill but on the Oregon side)

*Patsy Bethel  
Historian*

## FROM THE EDITOR

The deadline for articles is the board meeting, if it needs to be typed. If the article is sent via e-mail the deadline is the Saturday after the board meeting.

**Phone: (208) 362-3941**  
**E-mail: WLR\_DKR@MSN.COM**  
**My mailing Address is:**  
**Doug Renken**  
**12843 S. Five Mile Rd.**  
**Kuna, ID 83634**

## Electronic Grindings

Thanks to those who signed up for the electronic Grindings. Not only does this save the club money it helps save me time putting on labels and postage. Currently it costs around \$1.70 per issue or \$20.40 per year to print and mail each newsletter.

If you would like to receive the Grindings newsletter through e-mail let me know. Please send an e-mail to WLR\_DKR@msn.com and I will add you to our e-mail list. The Grindings will be sent in PDF format.

## SAVE STAMPS

Just a note to remind people to save their postage stamps to donate to the Federation. The stamps are sold and the proceeds are donated to cancer research. Cut at least 1/4 inch margin around the stamps. You can turn them into Chuck McCreath at our next meeting. **THANK YOU!**

## "CODE OF ETHICS"

I will respect both private and public property and will do no collecting on privately owned land without permission from the owner.

I will keep informed on all laws, regulations or rules governing collecting on public lands and will observe them.

I will, to the best of my ability, ascertain the boundary lines of property on which I plan to collect.

I will use no firearms or blasting material in collecting areas.

I will cause no willful damage to property of any kind such as fences, signs, buildings, etc.

I will leave all gates as found.

I will build fires only in designated or safe places and will be certain they are completely extinguished before leaving the area.

I will discard no burning material - matches, cigarettes, etc.

I will fill all excavation holes which may be dangerous to livestock.

I will not contaminate wells, creeks, or other water supplies.

I will cause no willful damage to collecting material and will take home only what I can reasonably use.

I will practice conservation and undertake to utilize fully and well the materials I have collected and will recycle my surplus for the pleasure and benefit of others.

I will support the rockhound project H.E.L.P (Help Eliminate Litter Please) and will leave all collecting areas devoid of litter, regardless of how found.

I will cooperate with field trip leaders and those in designated authority in all collecting areas.

I will report to my club or federation officer, Bureau of Land Management or other authorities, any deposit of petrified wood or other materials on public lands which should be protected for the enjoyment of future generations for public educational and scientific purposes.

I will appreciate and protect our heritage of natural resources.

I will observe the "Golden Rule", I will use Good Outdoor Manners and will at all times conduct myself in a manner which will add to the stature and Public Image of Rockhounds everywhere.

## THE GRINDINGS

is the monthly newsletter of the Idaho Gem Club, Inc., associated with the Northwest Federation of Mineralogical Societies. Permission to copy is freely granted when proper credit is given to both the publication and the author. Articles without bylines are written by the Editor or President.

**CHECK OUT THE CLUB WEBSITE!**

[www.idahogemclub.com](http://www.idahogemclub.com)



# Workshop Report

We will be starting the workshops this month so dig out your favorite slab. The shop will be open at 6:30pm and run until 9:30pm. If you are interested please sign up at the meeting or call me at home. We also offer wire wrapping which carries a small charge for the wire. The address is 12843 S Five Mile Rd off of Kuna Rd. I will need instructors so please step forward and volunteer. It usually takes about five to seven depending on the interest. If you aren't able to make this month we will be having them throughout the year so everyone who wants should get a chance to learn how to cab. All we ask

is that you please help clean up the machines at the end of the evening. Hope to see you all there.

*Willa Renken*  
*Workshop Chairmen*

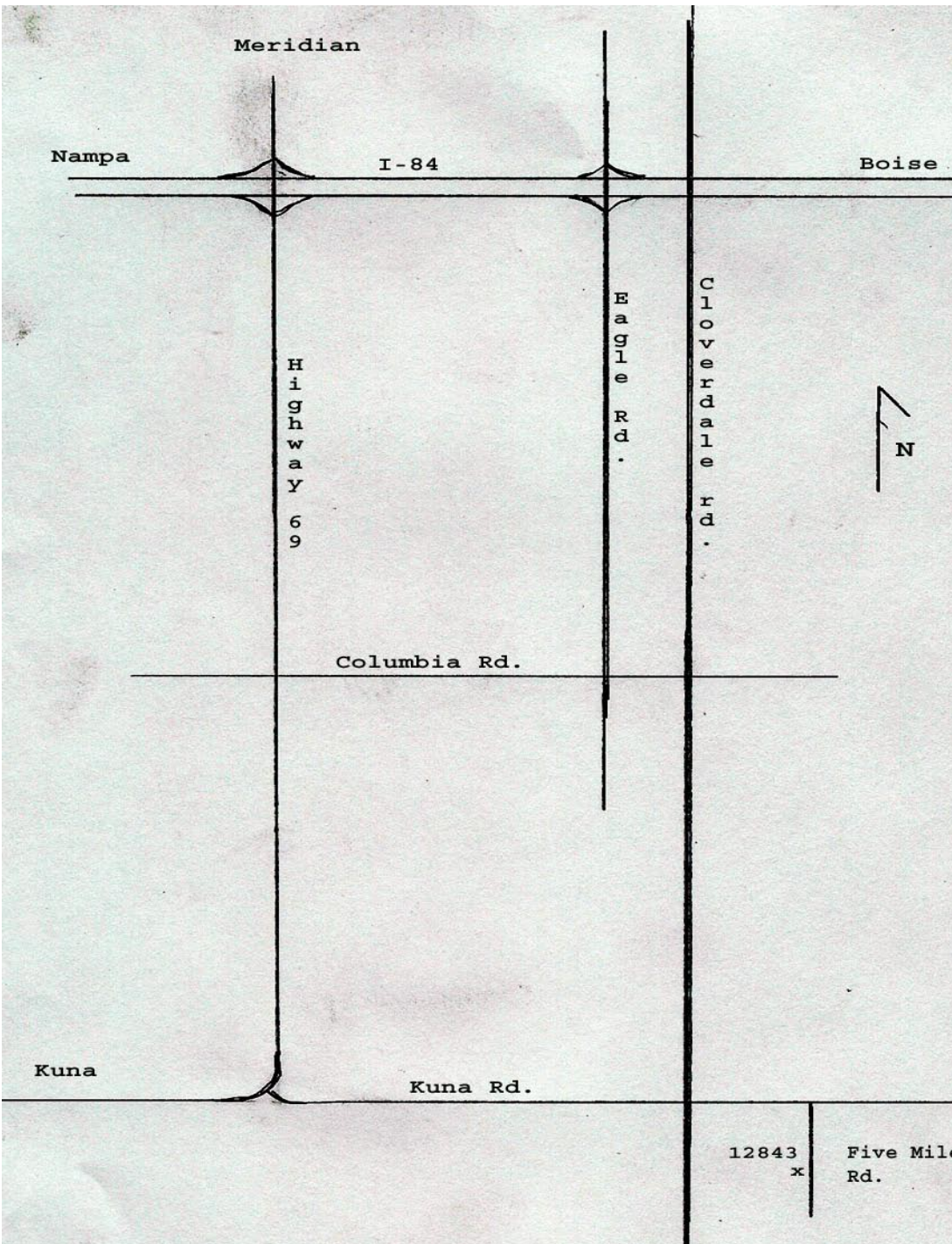

Workshop address:  
12843 S. Five Mile Rd.  
Phone 362-3941

The purpose of the Idaho Gem Club is to promote mutual, educational and scientific interests and benefits of its members in mineralogy, geology, gemology, the art of lapidary and kindred arts and sciences.

**Dues:**

\$12.00 per person  
\$15.00 per couple  
\$17.50 per family

**Subscription:**

\$10.00 per year

**General Meeting:**

3rd. Tuesday of each  
Month at 7:30 p.m.

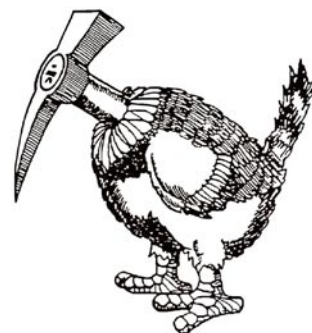
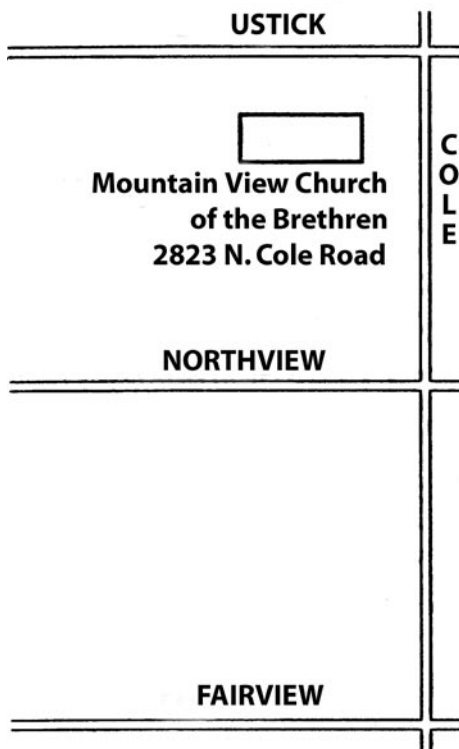

The Whangdoodle Bird  
(Often seen on field trips)



**Idaho Gem Club, Inc.**

P.O. Box 8443  
Boise, Idaho 83707-2443